

52 Series CAT III 600V AC/DC Current Clamp-On Probes

The **52 Series CAT III 600V AC/DC Current Clamp-On Probes** are high performance current converters incorporating a Hall Effect sensor within a split core window current transformer with low ratio and phase errors, and specifically designed as an accessory for CHK Power Quality instruments and used in CAT III 600V environments.



Figure 1: 52 series CAT IV 600V AC/DC current clamp-on probe

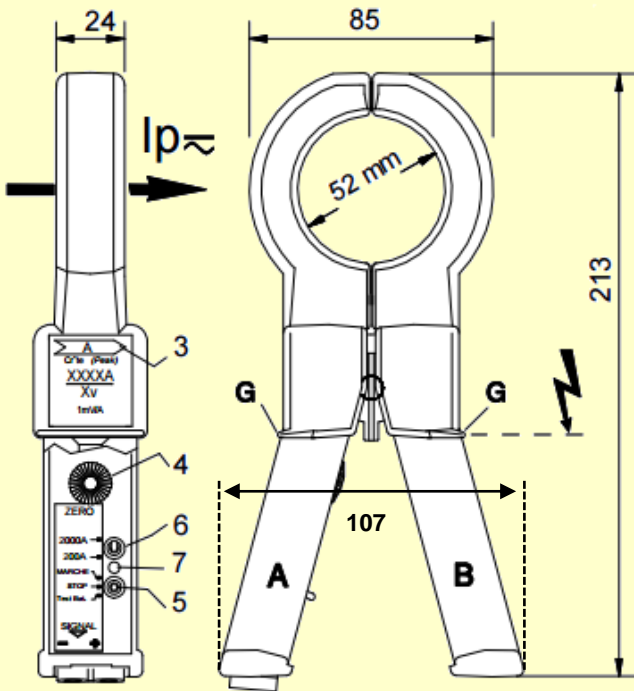

Figure 2: Dimensions

The zero adjust knob and the power indicator LED are located on the inside of a trigger arm.

Connection to the MIRO

Once connected, the MIRO automatically detects and energises the AC/DC clamp. The red LED will glow to indicate that the clamp is energised.

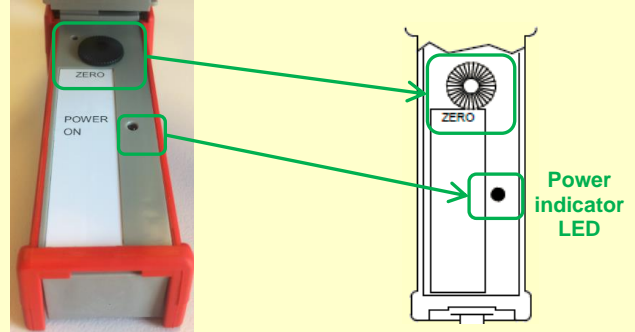

Figure 3: Zero adjust knob and power indicator LED

Part number	Rated Primary	To be used with
1ADC250	250A	MIRO PQ45 Power Quality Logger and Analyser
1ADC1000	1000A	
1ADCR250	250A	MIRO PQ35 Power Quality Logger and Analyser
1ADCR1000	1000A	

Table 1: Instrument accessories

Specifications

Rated input current	250A or 1000A AC/DC (refer to table 1)
Maximum input current	120% of rated current
Output signal	2V at rated current
Zero adjustment	Yes
Sensor technology	Hall effect
Burden	10kΩ
Accuracy	2% (10-120)% of rated
Phase error	4° @ 1kHz
Frequency range	10kHz (-3dB)
Working voltage	600V
Dielectric strength	4kV@50Hz for 1 minute
Dimensions (H x W x L)	(24 x 107 x 213) mm
Jaw aperture	52 mm
Lead length / Weight	2m / 600 grams
Power indicator	Red LED
Enclosure colour	Red
Operating temperature	-10°C to 50°C
Protection class	CAT III 600V, pollution degree II, IEC 61010-2
Environment	Indoors

Note: To ensure good electrical contact, it is recommended the iron core contact surfaces be cleaned by applying cleaning alcohol and wiping the surfaces with a lint free cloth.